

ISSUE DATE: MARCH 2019

FX6SL- MCU

REACH-IN MERCHANDISER



KYSOR WARREN
epta refrigeration

General Case Data	# of Doors			
	2	3	4	5
Total Display Area (ft ²)	26.10	39.20	52.20	65.30
Cubic Capacity (ft ³)	64.10	95.70	127.10	158.60
Max Shelf Depth (in) [Top/Bottom]	27/27	27/27	27/27	27/27
Weight (lb)	-	-	-	-
Refrigeration Data (All data is per side)				
Evaporator Temperature (°F)				
Frozen Food	-10	-10	-10	-10
Ice Cream	-18	-18	-18	-18
Discharge Air Temperature (°F)				
Frozen Food	-2 to -4	-2 to -4	-2 to -4	-2 to -4
Ice Cream	-8 to -11	-8 to -11	-8 to -11	-8 to -11
Discharge Air Velocity (fpm)	200-300	200-300	200-300	200-300
Fan Speed (rpm)	1800	1800	1800	1800
Conventional Thermal Load (Btuh per side)				
Frozen Food	2069	3104	4139	5174
Ice Cream	2293	3440	4586	5733
Refrigerant Type	R-448A	R-448A	R-448A	R-448A
Refrigerant Charge (lbs)	4.75	5.50	8.25	11.20
Superheat Setpoint (°F)	6-8	6-8	6-8	6-8
Electrical Data (Amps/Qty)				
Power Supply (Volts/Hertz/Phase)				
Circuit 1 - Case Circuit (115 V)	115V/60HZ/1PH	115V/60HZ/1PH	115V/60HZ/1PH	115V/60HZ/1PH
Circuit 2 - Modular Condensing Unit (208 V)	208V/60HZ/1PH	208V/60HZ/1PH	208V/60HZ/1PH	208V/60HZ/1PH
Evaporator Fan Motor Amps (115 V)	0.58	0.87	0.87	1.16
Anti-sweat Heater Amps (115 V)	1.70	2.48	3.29	4.09
Lights Amps (115 V)	0.33	0.48	0.64	0.80
Drain Heater Amps	0.39	0.65	0.91	1.17
Defrost Heater Amps (208 V)	6.73	10.10	13.46	16.83
Condensate Pump Amps (115 V)	0.70	0.70	0.70	0.70
Evaporation Pan Heater Amps (115 V)	8.33	8.33	8.33	8.33
Compressor RLA	7.40	12.00	13.90	23.60
Compressor LRA	40.30	56.00	75.00	104.00
Condenser Fan Amps	1.10	1.10	1.10	2.20
Refrigeration Cycle Amps	11.64	12.86	13.83	15.08
Defrost Cycle Amps	11.45	12.64	13.87	15.09
Case Circuit Minimum Circuit Ampacity (Circuit 1)	14.55	16.08	17.29	18.85
Case Circuit Maximum Overcurrent Protection (Circuit 1)	15	15	15	15
Condensing Unit Minimum Circuit Ampacity (Circuit 2)	10.35	16.10	18.48	31.70
Condensing Unit Maximum Overcurrent Protection (Circuit 2)	15	25	30	50

APPLICATIONS



Defrost Data (Electric)			
Defrosts per Day	Failsafe Duration (min) ¹	Termination Temp (°F)	Drip Time (min)
1	45	N/A	0

¹ At ASHRAE conditions. For conditions above 75°F, 55% RH, increase defrost time by 15 min. Type I refrigerator, intended for use in an area where the environmental conditions are controlled and maintained that conditions do not exceed 75°F and 55% relative humidity. Kysor Warren, whose policy is one of continuous improvement, reserves the right to change at any time specifications, designs, or prices without incurring obligation. DOE 2017 Compliant



The above case model has case lengths that are UL and NSF approved.

FX6SL- MCU

REACH-IN MERCHANDISER

FX6SL CROSS VIEW

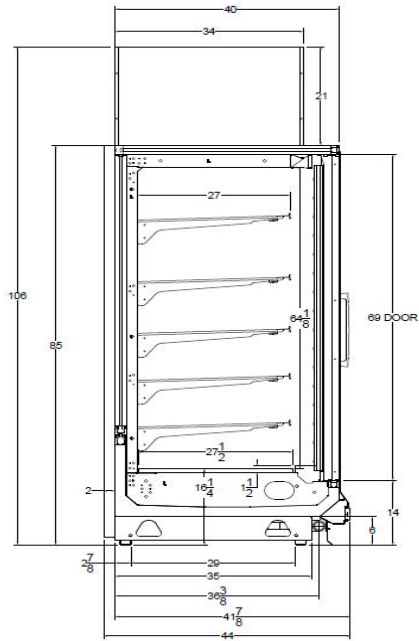

Add 3" thickness for a pair of ends.

FX6SL PLAN VIEW

