







ISSUE DATE: SEPTEMBER 2018

DX8LN - STRATUS



MULTI-DECK SPECIFICATION SHEET



KYSOR WARREN
epta refrigeration

Case Length (ft)					APPLICATIONS
General Case Data	4'	6'	8'	12'	
Total Display Area (ft ²)	21.40	32.10	42.80	64.20	
Cubic Capacity (ft ³)	53.60	80.40	107.20	160.80	
Max Shelf Depth (in) [Top/Bottom]	22/22	22/22	22/22	22/22	
Weight (lb)	-	-	-	-	
Refrigeration Data (General)					
Discharge Air Velocity (fpm)	200-300	200-300	200-300	200-300	
Fan Speed (rpm)	1900	1900	1900	1900	
Discharge Air Temp (°F)	33	33	33	33	
Conventional Thermal Load, Single (Btuh) one row of canopy LED	5698	8554	11396	17108	
Parallel Thermal Load, Single (Btuh) one row of canopy LED	5274	7918	10549	15837	
Additional Btuh per ft LED - Canopy / Shelf & Nose	13 / 11	13 / 11	13 / 11	13 / 11	
Refrigeration Data (HFC)					
Evaporator Temperature (°F)	26	26	26	26	
Superheat Setpoint (°F)	6 - 8	6 - 8	6 - 8	6 - 8	
Estimated Refrigerant Charge (lbs)	2.554	3.818	5.109	7.637	
Refrigeration Data (Glycol)					
Supply Temperature (°F)	20	20	20	20	
Flow (GPM)	1.447	2.172	2.895	4.343	
Fluid %	35	35	35	35	
Pressure Drop (PSID)	2.0	4.4	2.0	4.4	
Electrical Data (Amps/Watts)					
115V/60Hz, 1 Phase					
Fans	0.33	0.66	0.66	1.32	
Canopy Lights (Per row)					
GE LED	0.22	0.33	0.44	0.67	
Shelf Lights (Per row)					
GE LED	0.08	0.10	0.15	0.23	
Defrost Data (off Cycle)					
Defrosts per Day	Failsafe Duration (min) ¹	Termination Temp (°F)	Drip Time (min)		
6	18	47	0		

1 At ASHRAE conditions. For conditions above 75°F, 55% RH, increase defrost time by 15 min. Type I refrigerator, intended for use in an area where the environmental conditions are controlled and maintained that conditions do not exceed 75°F and 55% relative humidity. Kysor Warren, whose policy is one of continuous improvement, reserves the right to change at any time specifications, designs, or prices without incurring obligation. DOE 2017 Compliant



ANSI / NSF 7

The above case model has case lengths that are UL and NSF approved.

1 At ASHRAE conditions. For conditions above 75°F, 55% RH, increase defrost time by 15 min. Type I refrigerator, intended for use in an area where the environmental conditions are controlled and maintained that conditions do not exceed 75°F and 55% relative humidity. Kysor Warren, whose policy is one of continuous improvement, reserves the right to change at any time specifications, designs, or prices without incurring obligation. DOE 2017 Compliant



The above case model has case lengths that are UL and NSF approved.

DX8LN - STRATUS

MULTI-DECK SPECIFICATION SHEET

DX8LN CROSS VIEW

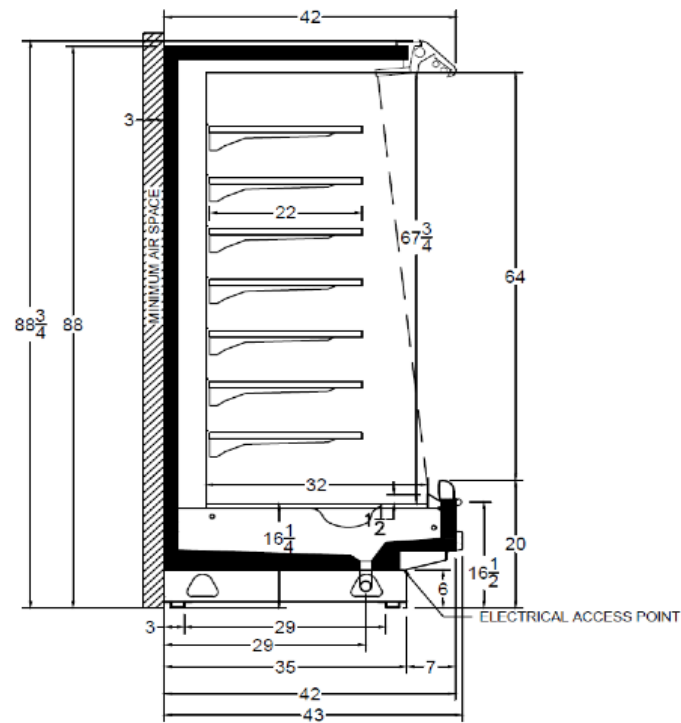

Add 3" thickness for a pair of ends.

DX8LN PLAN VIEW

