

ISSUE DATE: NOVEMBER 2018

MX6LN - STRATUS

MULTI-DECK SPECIFICATION SHEET



KYSOR WARREN
epta refrigeration

General Case Data	Case Length (ft)				APPLICATIONS
	4'	6'	8'	12'	
Total Display Area (ft ²)	18.52	27.78	37.04	55.57	
Cubic Capacity (ft ³)	48.30	71.60	96.50	143.20	
Max Shelf Depth (in) [Top/Bottom]	16/22	16/22	16/22	16/22	
Weight (lb)	-	-	-	-	
Refrigeration Data (General)					
Discharge Air Velocity (fpm)	200-225	200-225	200-225	200-225	
Fan Speed (rpm)	2200	2200	2200	2200	
Discharge Air Temp (°F)	30	30	30	30	
Conventional Thermal Load, Single (Btuh) one row of canopy LED	6000	9000	12000	18000	
Parallel Thermal Load, Single (Btuh) one row of canopy LED	5525	8288	11050	16575	
Additional Btuh per ft LED - Canopy / Shelf & Nose	13 / 11	13 / 11	13 / 11	13 / 11	
Refrigeration Data (HFC)					
Evaporator Temperature (°F)	23	23	23	23	
Superheat Setpoint (°F)	6 - 8	6 - 8	6 - 8	6 - 8	
Estimated Refrigerant Charge (lbs)	2.214	3.310	4.428	6.619	
Refrigeration Data (Glycol)					
Supply Temperature (°F)	20	20	20	20	
Flow (GPM)	1.421	2.132	2.843	4.265	
Fluid %	35	35	35	35	
Pressure Drop (PSID)	1.9	4.4	1.9	4.4	
Electrical Data (Amps/Watts)					
115V/60Hz, 1 Phase					
Fans	0.41	0.83	0.83	1.24	
Canopy Lights (Per row)					
GE LED	0.22	0.33	0.44	0.67	
Shelf Lights (Per row)					
GE LED	0.08	0.10	0.15	0.23	

Defrost Data (off Cycle)			
Defrosts per Day	Failsafe Duration (min) ¹	Termination Temp (°F)	Drip Time (min)
6	29	45	0

¹ At ASHRAE conditions. For conditions above 75°F, 55% RH, increase defrost time by 15 min. Type I refrigerator, intended for use in an area where the environmental conditions are controlled and maintained that conditions do not exceed 75°F and 55% relative humidity. Kysor Warren, whose policy is one of continuous improvement, reserves the right to change at any time specifications, designs, or prices without incurring obligation. DOE 2017 Compliant



ANSI / NSF 7
The above case model has case lengths that are UL and NSF approved.

MX6LN - STRATUS

MULTI-DECK SPECIFICATION SHEET

MX6LN CROSS VIEW

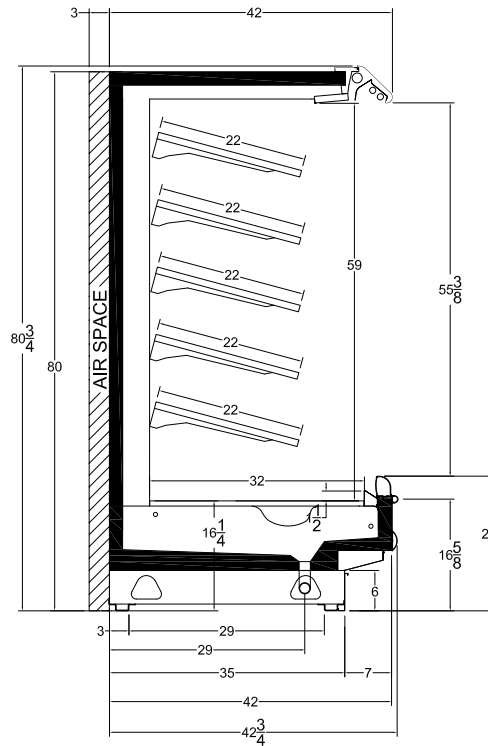

Add 3" thickness for a pair of ends.

MX6LN PLAN VIEW (SINGLE COIL)

