

# QWSTGE - Legacy Island

## ISLAND SPECIFICATION SHEET



Case Length (ft) APPLICATIONS

General Case Data		4' End
Total Display Area (ft <sup>2</sup> )		21.88
Cubic Capacity (ft <sup>3</sup> )		20.91
Max Shelf Depth (in) [Top/Bottom]		NA
Weight (lb)		-
Refrigeration Data (All data is per side)		
Evaporator Temperature (°F)		
Frozen Food		-15
Ice Cream		-20
Dairy		24
Discharge Air Temperature (°F)		
Frozen Food		-11
Ice Cream		-16
Dairy		30
Discharge Air Velocity (fpm)		
		175
Parallel Thermal Load (Btuh per side)		
Frozen Food		3214
Ice Cream		3554
Dairy		1901
Conventional Thermal Load (Btuh per side)		
Frozen Food		3354
Ice Cream		3708
Dairy		2106
Superheat Setpoint (°F)		
		6-8
Estimated Refrigerant Charge (lbs)		
		3.752
Electrical Data (Amps/Watts)		
ECM Fan Data (Amps/Qty)		
		0.42 / 2
Anti-Sweat Heater Amps (I.C./F.F./Med.Temp)		
		1.83
Drain Heater Amps		
Electric		0.52
Hot Gas		0.39
Defrost Heater Amps (Low/Dual Temp)		
		5.90



Defrost Data				
	Per Day	Fail Safe (min) <sup>1</sup>	Termination (°F)	Drip Time (min)
Electric	1	60	47	0
Hot Gas	1	20	47	0
Off Cycle	4	35	47	0

<sup>1</sup> At ASHRAE conditions. For conditions above 75°F, 55% RH, increase defrost time by 15 min. Type I refrigerator, intended for use in an area where the environmental conditions are controlled and maintained that conditions do not exceed 75°F and 55% relative humidity. Kysor Warren, whose policy is one of continuous improvement, reserves the right to change at any time specifications, designs, or prices without incurring obligation. DOE 2017 Compliant



ANSI / NSF 7  
The above case model has case lengths that are UL and NSF approved.

# QWSTGE - Legacy Island

## ISLAND SPECIFICATION SHEET

### QWSTGE CROSS VIEW

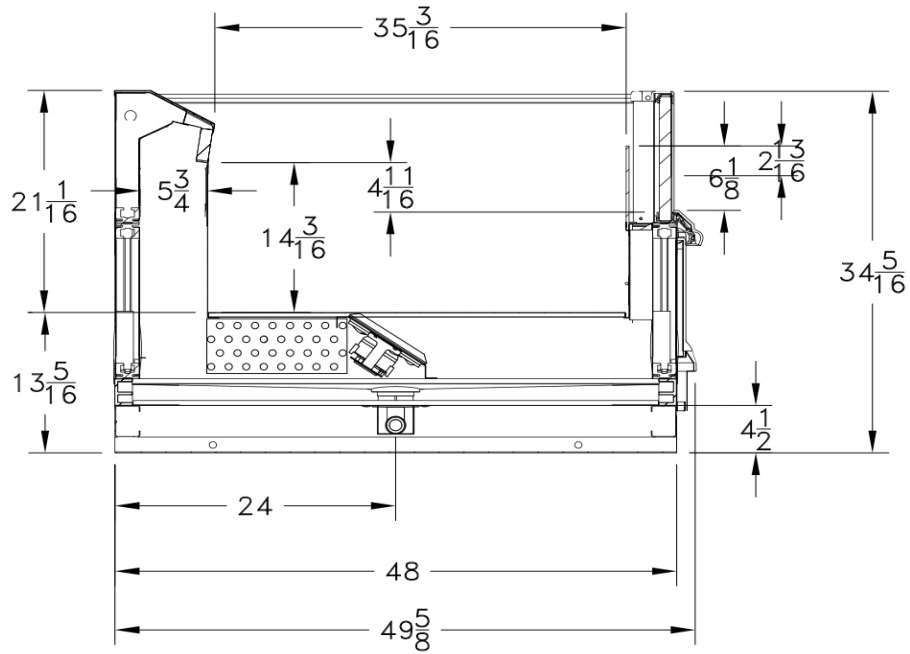

Add 3" thickness for a pair of flat ends.

### QWSTGE PLAN VIEW

